

结构特点 Design features

- 内装、单端面、多弹簧、平衡型、传动套传动结构，任意旋向，压力均匀，结构紧凑，安装方便；
- 安装尺寸符合API 610标准。
- 辅助密封圈为聚四氟乙烯、填充聚四氟乙烯和柔性石墨材料制作的楔形环，提高了密封的使用温度和耐磨性；
- 静环配标准A静环，另可配P、PP静环。
- Internally mounted, single face, multi-spring, balanced structure and driven by brace ear and claw transmission, any rotation direction, compact construction, it can be mounted conveniently.
- Conform to the standard of API 610.
- PTFE or flexible graphite wedge used as a secondary seal. For use in corrosive fluids and high temperature applications.
- With "A" seat, "P" and "PP" types stationary seats are available.

材料 Materials(to DIN24960)

- 旋转环 Rotary Ring: B、U1、U2、Q1、Q2
- 静止环 Stationary Ring: U1、U2、Q1、Q2、V1
- 辅助密封 Auxiliary Seal: T1、G
- 弹簧及其他结构件材料 Spring and Other Parts: G、M4



适用范围 Operating limits

- 压力 Pressure: ≤5.2MPa
- 温度 Temperature: -100~500°C
- 线速度 Speeds: ≤25m/sec

用途 Applications

用于离心泵类、搅拌器和其它类似的旋转轴设备，多用于串级密封进行二次防漏。
Used in all types of rotating equipment, pumps, mixers, agitators and compressors, wedge construction of the secondary sealing element virtually eliminates leakage.

介质 Medium

油类、水、盐、非结晶性溶剂、有机溶剂及其它弱腐蚀性溶液。
Oil, water, salt, noncrystalline agent, organic solvents and other weak corrosive fluid.

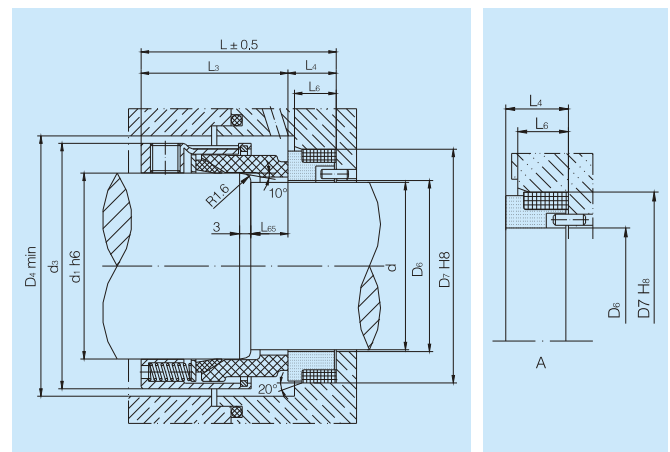

型号 Model	d	d1	d3	D4	D6	D7	L1	L3	L4	L6	L65
CN 109B-0.625	12.7	15.88	30.7	34	13.4	25.40	35.0	27.0	7.95	6.4	4.8
CN 109B-0.750	15.9	19.05	34.0	37	16.6	31.75	40.3	30.0	10.3	8.8	4.8
CN 109B-0.875	19.1	22.23	37.2	40	19.7	34.93	42.3	32.0	10.3	8.8	6.4
CN 109B-1.000	22.2	25.40	40.3	43	22.9	38.10	43.3	33.0	10.3	8.8	6.4
CN 109B-1.125	25.4	28.58	43.5	46	26.1	41.28	46.1	35.0	11.1	9.5	7.9
CN 109B-1.250	28.6	31.75	48.3	51	29.3	44.45	46.1	35.0	11.1	9.5	7.9
CN 109B-1.375	28.6	34.93	51.5	54	29.3	44.45	48.1	37.0	11.1	9.5	8.7
CN 109B-1.500	31.8	38.10	54.6	58	32.4	47.63	48.1	37.0	11.1	9.5	8.7
CN 109B-1.625	34.9	41.28	61.0	64	35.6	50.80	56.1	45.0	11.1	9.5	8.7
CN 109B-1.750	38.1	44.45	64.2	67	38.8	53.98	56.1	45.0	11.1	9.5	9.5
CN 109B-1.875	41.3	47.63	67.3	70	42.4	60.33	57.7	45.0	12.7	11.0	9.5
CN 109B-2.000	44.5	50.80	70.5	73	45.5	63.50	57.7	45.0	12.7	11.0	9.5
CN 109B-2.125	47.6	53.98	76.9	80	48.7	66.68	64.7	52.0	12.7	11.0	11.1
CN 109B-2.250	50.8	57.15	80.0	83	51.9	69.85	64.7	52.0	12.7	11.0	11.1
CN 109B-2.375	54.0	60.33	83.2	86	55.0	76.20	66.3	52.0	14.3	12.7	11.1
CN 109B-2.500	57.2	63.50	86.4	89	58.2	79.38	66.3	52.0	14.3	12.7	11.1
CN 109B-2.625	60.3	66.68	89.6	92	61.4	82.55	66.3	52.0	14.3	12.7	11.1
CN 109B-2.750	63.5	69.85	92.7	96	64.6	85.73	66.3	52.0	14.3	12.7	11.1
CN 109B-2.875	66.7	73.03	95.9	99	67.7	85.73	67.9	52.0	15.9	14.3	11.1
CN 109B-3.000	69.9	76.20	97.5	100	70.9	88.90	67.9	52.0	15.9	14.3	11.1